

# ULTIMATE METER CHALLENGE

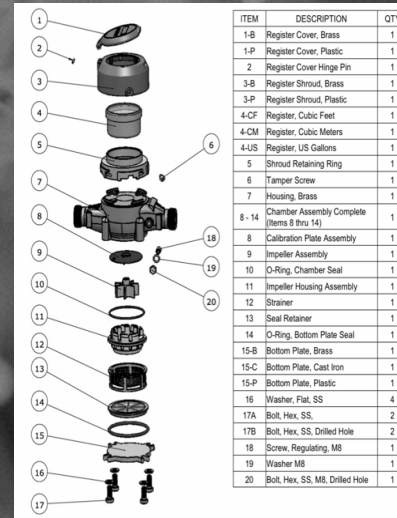

SPONSORED BY ZENNER USA

03.31.2021

# INTRODUCTION



- **1.** This Competition is to test and measure individual's; how quickly, totally, and accurately can they assemble a working meter. All parts will be assembled to the diagram given, meter will be tested for leaks, meter will be disassembled to ensure it was assembled properly and no parts are missing.
- **2.** This is a test of skill for individuals. To facilitate many competitors, we will be conducting a single elimination tournament, where the loser of each match-up is immediately eliminated from the **tournament**. Each winner will play another in the next round, until the final match-up, whose winner becomes the **tournament** champion.
- **3.** Each individual competitor will be required to completely assemble a water meter commonly utilized by water utilities for residential customers. The faster build with zero leaks in each match up will be the winner and move on to next bracket.

## INTRODUCTION Cont



- **4.** Each competitor will be furnished with a meter kit. This kit will contain a completely disassembled meter. In addition, random parts will be added to this kit. These random parts could/could not be related to the meter. Each kit will have the same extra parts, this will ensure that the competitor is thoroughly familiar with all parts of the meter he/she is assembling.
- **5.** A time period of no more than five (5) minutes shall be allowed for each competitor to complete his/her meter assembly.
- **6.** On first day of competition we will be doing time trials. Competitors will have the opportunity to be timed twice on the assembly of the meter. The best time of both times will be recorded to record. The top 16 times will move on to the single elimination challenge. The single elimination challenge will begin the following day.

## HOW AND WHO WILL WIN

Each competitor will be ready to compete on first day of challenge. Competitor will have two opportunities to be timed and recorded. The best time from both will be recorded to record. All competitors in the round must completely assemble meter to have a qualifying time of record. The meters will then be tested for leaks, and function.

The best time of both assembly times will be the competitors OFFICIAL TIME.

In order to advance, the best time recorded will need to be on the top 16 best times. Only the top 16 competitors will advance to the Single elimination Tournament. 16 Competitors will go head-to-head to see who can assemble meter the fastest and correctly.

A **single-elimination, knockout**, or sudden death **elimination tournament** where the loser of each match-up is immediately eliminated from the **tournament**. Each winner will compete in the next round, until the final match-up, whose winner becomes the **tournament** champion. Third place will be the matchup of the eliminated competitors from the final four contestants who didn't advance to the finals.



- You will receive two (2) practice meters to put together before the contest, one fully assembled and one unassembled. You do not have to return these meters to Zenner.
- On Monday evening and all day Tuesday, September 13-14, Zenner will host timed trials at their booth in the WaterPro Conference Exhibit Hall.
- Each competitor will be ready to compete on Monday evening. Since the exhibit hall closes at 5:30, we will resume time trials Tuesday morning.
- Competitors will have the opportunity to be timed twice on the assembly of the meter. The best time of both times will be recorded to record. The top 16 times will move on to the single elimination challenge. The single elimination challenge will take place at 5:00 pm on Wednesday during the reception in the exhibit hall.
- All competitors in the round must completely assemble meter to have a qualifying time of record. The meters will then be tested for leaks, and function.
- In order to advance, the best time recorded will need to be on the top 16 best times. Only the top 16 competitors will advance to the Single elimination Tournament. 16 Competitors will go head-to-head to see who can assemble meter the fastest and correctly.
- A **single-elimination, knockout**, or sudden death **elimination tournament** where the loser of each match-up is immediately eliminated from the **tournament**. Each winner will compete in the next round, until the final match-up, whose winner becomes the **tournament** champion. Third place will be the matchup of the eliminated competitors from the final four contestants who didn't advance to the finals